



PRODUCT CATALOGUE

a Better Slurry Pump Experience

Wada Group specialise in providing pump solutions and alternatives, for the mining and mineral processing sectors worldwide. Since it's South African arrival in 2009, and the establishment of it's warehouse in 2015. Wada has cemented it's efficiency and timeous service delivery to it's customers, by which all benefit of it's time-saving structures.

Our products are horizontal slurry pumps, vertical slurry pumps, rubber wear parts, high chrome wear parts, impellers, cover plate liners, frame plate liners, volute liners, throat bushes, frame plate liner inserts, cast iron parts, ductile iron pump casings, cover plates and frame plates, as well as bearing housings and bases.

By understanding the processes and demands of the mining sector, we offer comprehensive services tailored to customer needs. It's global network of service facilities are fully equipped with the latest technology and equipment to ensure that pump specifications and performances, are optimal and that downtime is at a minimum.

High quality products at competitive pricing is offered, because of the support of several manufacturing facilities forming part of it's manufacturing capability.

All manufactured products are supplied with a product warranty.

Wada South Africa is a B-BBEE level 2 company.

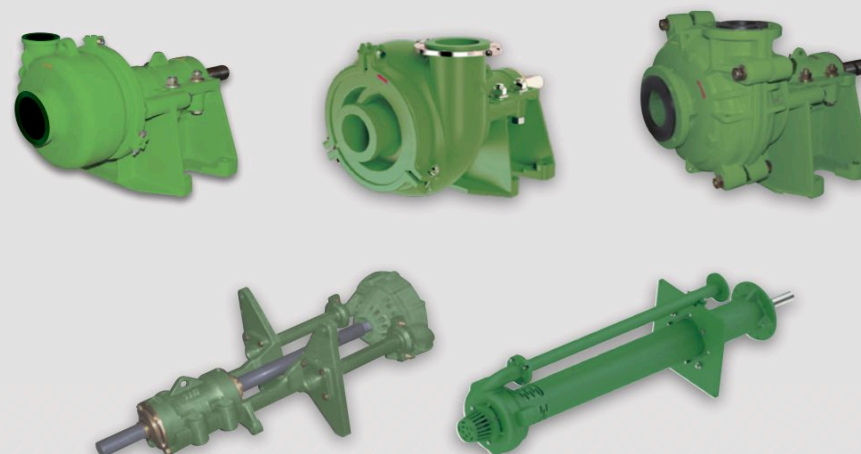



A better slurry Pump experience

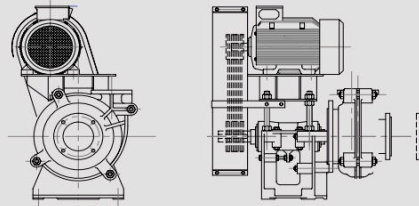

Slurry Pump Aftermarket

Wada Group is a major manufacturer and service provider in delivering ideal alternative solutions for Mineral Processing and Mining industry world wide. We play a key role in mineral processing equipment for slurry pumps and rubber, metal wear parts and other spares for global mining ranging from quarrying, mineral processing, electrical power sector and to any general industry.

Reliability

Wada Group has a strong relationship with major slurry pumps manufacturers since 2007, as a preferential supplier over the last 10 years. Wada Group has expanded its market presence across 3 continents, in Australia, Africa and America. Due to our sound, long-term business partnership we provide customers with quality alternative slurry pump spares.

Faster delivery

Wada Group has witnessed it's market share in Africa increase efficiently to customers since the establishment of South African warehouse in 2015. Our South African warehouse has stocks levels to the value of multi-millions of \$US Dollars. This shortens the lead time to our customer by 40 days. In this way, our clients, with urgent need in particular, are enjoying the time-saving services offered by Wada. What's more, the companies management has planned to expand it's warehouse network globally in the next 5 years.

Cost effective

Due to the continuous demand for wear components from the mining industry, it often becomes necessary to find an alternate supply to be found when demand outstrips supply. Wada Group, with the back up of several manufacturing facilities, would like to be your business partner. By coming to us directly, you can enjoy factory pricing right on your own door step. As a result, Wada Group is able to make clients more room for creating more cost-savings.

CONTENT

A Series.....	Pg 3
B Series	Pg 4
S & SR Series.....	Pg 5
D Series.....	Pg 6
C Series.....	Pg 7
W Series.....	Pg 8

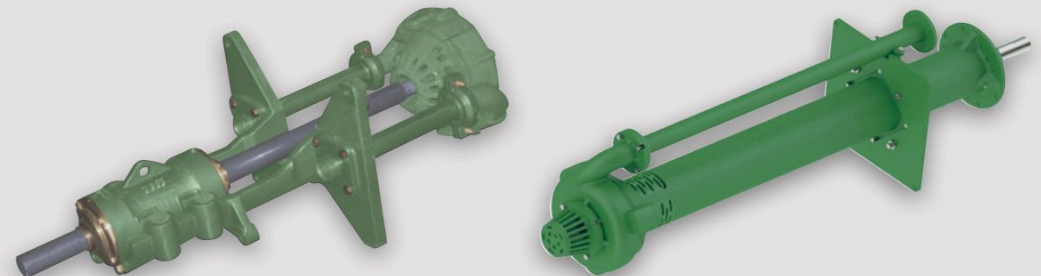

A SERIES

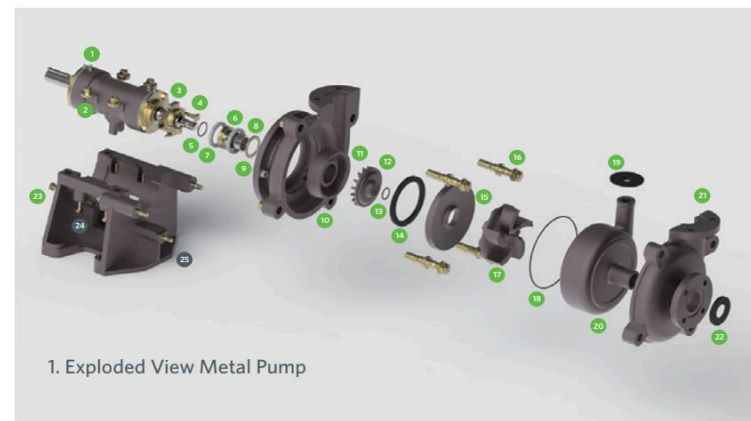

1. Exploded View Metal Pump

- 1 Bearing assembly
- 2 Clamp washer
- 3 Gland assembly
- 4 Gland bolt
- 5 Shaft O-Ring
- 6 Lantern Ring
- 7 Packing
- 8 Shaft Sleeve
- 9 Neck Ring
- 10 Frame Plate
- 11 Expeller Ring
- 12 Expeller
- 13 Impeller O-Ring
- 14 Expeller Seal
- 15 Frame Plate Liner Insert
- 16 Cover Plate Bolt
- 17 Impeller
- 18 Volute Frame Seal
- 19 Discharge Joint Ring
- 20 Volute
- 21 Cover Plate
- 22 Intake Joint Ring
- 23 Adjusting Screw
- 24 Base
- 25 Frame Plate Stud

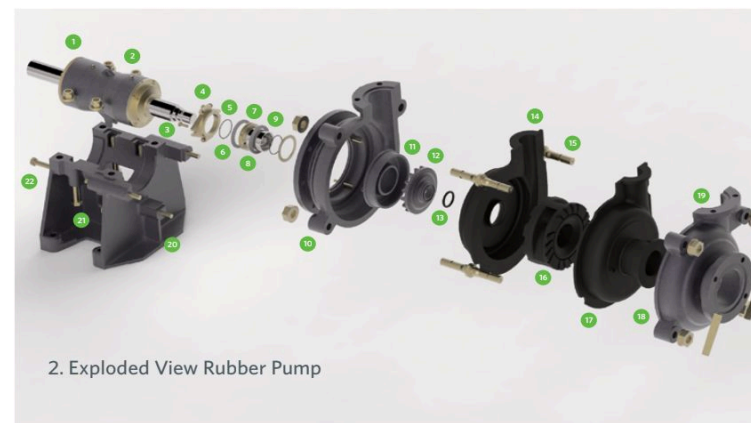

2. Exploded View Rubber Pump

- 1 Bearing assembly
- 2 Clamp washer
- 3 Gland bolt
- 4 Gland assembly
- 5 Shaft O-Ring
- 6 Neck Ring
- 7 Lantern Ring
- 8 Packing
- 9 Shaft Sleeve
- 10 Frame Plate
- 11 Expeller Ring
- 12 Expeller
- 13 Impeller O-Ring
- 14 Frame Plate Liner
- 15 Cover Plate Bolt
- 16 Impeller
- 17 Cover Plate Liner
- 18 Cover Plate
- 19 Frame Plate Stud
- 20 Base
- 21 Clamp Down bolt
- 22 Adjusting Screw

Design characteristics

The AHW range has been designed for corrosive and abrasive slurries.

Bearings assembly

- Short overhang on shaft dimension assists with shaft deflection as well as vibration.
- Dimensionally interchangeable to suit heavy duty bearing assemblies.

Casing liners

- Ease of maintenance design allows interchange ability with high-chrome elastomer and various other material options.

Impeller

- Various impeller designs to suit any application.
- Impeller adjustment via bearing assembly.
- Expulsion vanes on impeller shroud minimizes the recirculation, and reduced pressure in the stuffing box.
- Available in various materials to suit any application.

Natural Rubber

- Fine erosive and abrasive products can be pumped using natural rubber.
- Max tip speed for - 27,48m/s
- Max particles size - 10mm
- Natural Rubber can handle a Ph range of 2-14 at 23° degrees

27% Chrome

- Mild corrosive slurries can be pumped using 27 % Chrome
- Max tip speed for -34.5m/s.
- Max particle size-limited by impeller passage.
- Superb wear resistance to erosive/abrasive products with particles sizes greater than 0.1, in diameter provided by 27% chrome.
- Products consisting of Nitric (HNO3) And Sulphuric (H2SO4) acids within a PH range of 5 to 12 can be pumped successfully using 27% Chrome

Applications and Commodities

- General Processing
- Mill Circuit
- Coal Processing
- Power Industry
- Wet Crushers
- SAG Mil Discharge
- Ni Acid Slurry
- Coarse Sand
- Coarse Tailings
- Phosphate Matrix
- Minerals Concentrate
- Oil Sands
- Mineral Sands
- Pulp and Paper

Metal pump quick selection chart

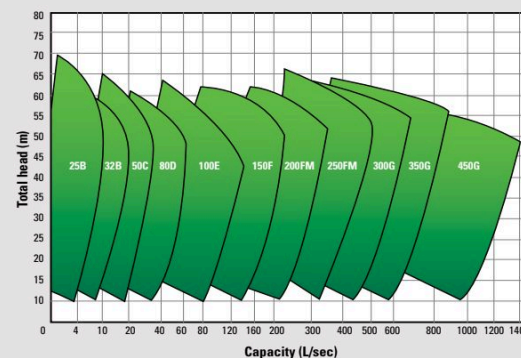

Rubber pump quick selection chart

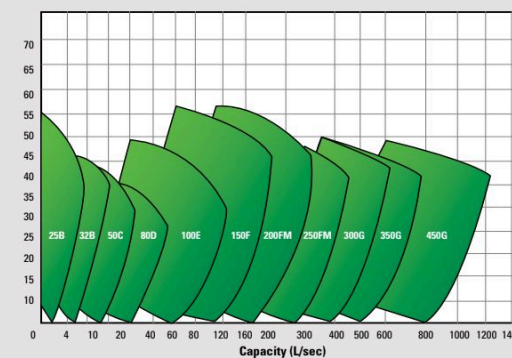

B SERIES



Exploded View MPW Range

www.wadagroup.com

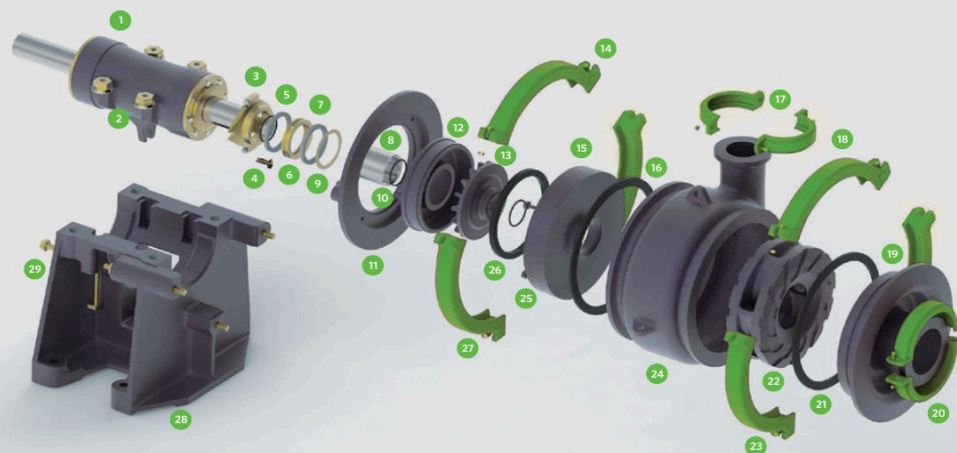

1 Bearing assembly	6 Lantern Ring	11 Frame Plate	16 Volute Frame Seal	21 Volute Frame Seal	26 Expeller Ring Seal
2 Clamp washer	7 Packing	12 Expeller Ring	17 Salvic Joint	22 Impeller	27 Clamp Ring bolt
3 Gland assembly	8 Shaft Sleeve	13 Expeller	18 Clamp Ring	23 Clamp Ring washer	28 Base
4 Gland bolt	9 Neck Ring	14 Clamp Ring	19 Cover Plate	24 Volute	29 Adjusting screw
5 Shaft O-Ring	10 Impeller O-Ring	15 Back Liner	20 Salvic Joint	25 FPLI Stud	

Design characteristics

The MPW pump is a cost-effective solution to medium duty slurry applications and the design allows for easy maintenance.

Bearings assembly

- A short overhang on shaft design, assists with shaft deflection as well as vibration
- A dimensional interchangeability to suit heavy duty bearing assemblies

Casing

- A solid casing design
- A ease of rotation and maintenance on casing with improved clamp design

Impeller

- Various impeller designs to suit any application
- Impeller adjustment via bearing assembly
- Expulsion vanes on impeller shroud, minimizing recirculation and reduced pressure in the stuffing box
- Various material to suit any application

Applications and Commodities

- Coarse sand
- Coarse trailings
- Mineral concentrate
- Heavy media
- Bottom/fly ash, lime grinding
- Oil sands
- Mineral sands
- Fine trailings
- Coal
- Floatation
- Wastewater
- Pulp, paper-pulp and paper

Flow Coverage Map

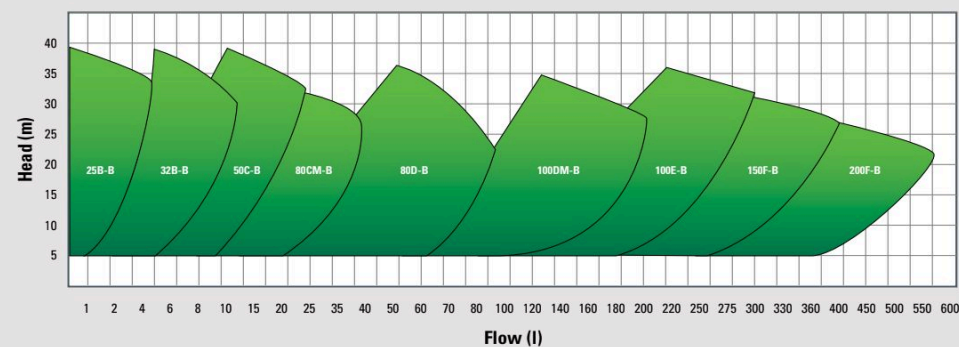

S and SR SERIES



Design characteristics

This heavy duty pump is designed for efficient reliability and durability handling abrasive slurries and corrosive fluids. Purposefully designed for using elastomer or alloy lined wet ends components, the bearing assembly allows the pump to operate in the "snore" condition without damage to the bearings.

This pump is designed for mining, chemical treatment, waste water treatment, gravel and general process application. The vertical spindle range is suited for all sumo applications: spillage and carbon transfer.

Bearings assembly

ASPW pumps are comprised of a cantilever shaft design.

Casing

Casings for the pump are available in an array of rubber or metallic options.

Impeller

Impellers are available in various rubber and metal options.

Applications and Commodities

- Coarse sand
- Coarse trailings
- Mineral concentrate
- Heavy media
- Bottom fly ash, lime grinding
- Oil sands
- Mineral sands
- Fine trailings
- Coal
- Flotation
- Wastewater
- Pulp, paper pulp

The following lengths are applicable to the spindle pumps below:

*L900	E
*L1200	G
*L1500	J
*L1800	L
*L2100	N
*L2400	Q

S (Metal)	SP (Metal)
40S-XXX-M (E,G,J,L)	PV40-XXX-M
65S-XXX-M (E,G,J,L)	QV65-XXX-M
100S-XXX-M (G,J,L,Q)	RV100-XXX-M
150S-XXX-M (J,L,N)	SV150-XXX-M
200S-XXX-M (J,L,N)	SV200-XXX-M

SR (Rubber)	SP (Rubber)
40SR-XXX (E,G,J,L)	PV40-XXX-R
65SR-XXX (E,G,J,L)	QV65-XXX-R
100SR-XXX (G,J,L,Q)	RV100-XXX-R
150SR-XXX (J,L,N)	SV150-XXX-R
200SR-XXX (J,L,N)	SV200-XXX-R

Metal and Rubber pump Flow Coverage Map

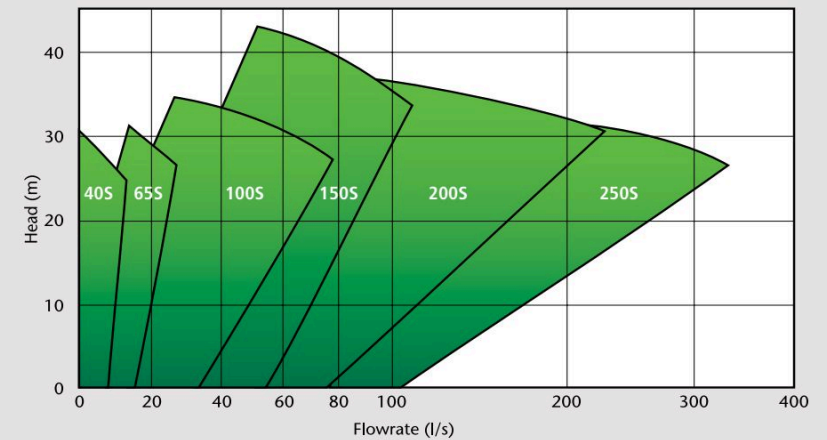

Pump Range

Discharge Size: 40mm - 250mm [Capacity of 17m³/h - 1000m³/h]

Head: 4m to 40m

Exploded View Metal and Rubber



- 1 Discharge Pipe
- 2 Mounting Plate
- 3 Column
- 4 Strainer
- 5 Backliner Seal
- 6 Backliner
- 7 Impeller O-Ring
- 8 Discharge pipe gasket
- 9 Impeller
- 10 Casing
- 11 Strainer
- 12 Bearing Assembly
- 13 Discharge Pipe
- 14 Mounting Plate
- 15 Column
- 16 Socket Head Protector
- 17 Strainer
- 18 Column Clamp
- 19 Backliner
- 20 Impeller O-Ring
- 21 Impeller
- 22 Casing
- 23 Strainer

D SERIES



Design characteristics

- Fully Cantilevered - Eliminates submerged bearings, packing, lip seals, and mechanical seals that other vertical slurry pumps typically require.
- Impellers - Unique double suction impellers; fluid flow enters the top as well as the bottom. This design eliminates shaft seals and reduces thrust load on the bearings.
- Large Particle - Large particle impellers are also available and enable passing unusually large solids.
- Bearing Assembly - The maintenance friendly bearing assembly has heavy duty roller bearings, robust housings, and a massive shaft.
- Casing - The metal pumps have a heavy walled abrasive resistant Cr27Mo chrome alloy casing. Rubber pumps have a molded rubber casing adhered to sturdy metal structures.
- Column and Discharge Pipe - The metal pump columns and discharge pipes are steel, and the rubber columns and discharge pipes are rubber covered.
- Upper Strainers - Snap in elastomer strainers fit in column openings to prevent overly large particles and unwanted refuse from entering casing of the pump.
- Lower Strainers - Bolt-on cast strainers on the metal pump and molded snap-on elastomer strainers on the rubber pumps protect the pump from oversize particles.

Bearings assembly

- Grease lubricated and sealed with labyrinths and v-seals
- Taper roller bearings and used drive and non-drive end bearings.

Impeller

- Open five vane top suction impeller design enables the handling of large solids.

Strainer

- Ease of maintenance design with quick release cotters.

Casing

- Salvic joints and two quick release cotters are used to lock the casing in place, allowed for ease of maintenance.

Applications and Commodities

- Coal preparation.
- Sand and gravel.
- Almost any tank, pit or hole in the ground slurry handling situation.
- Abrasive and/or corrosive slurries.
- Dewatering.
- Continuous operation.

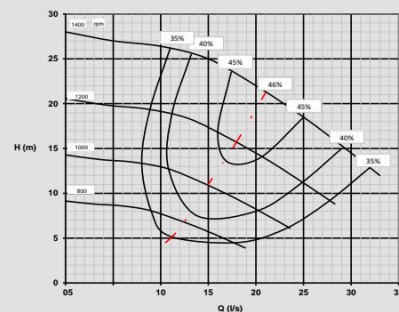

Exploded View

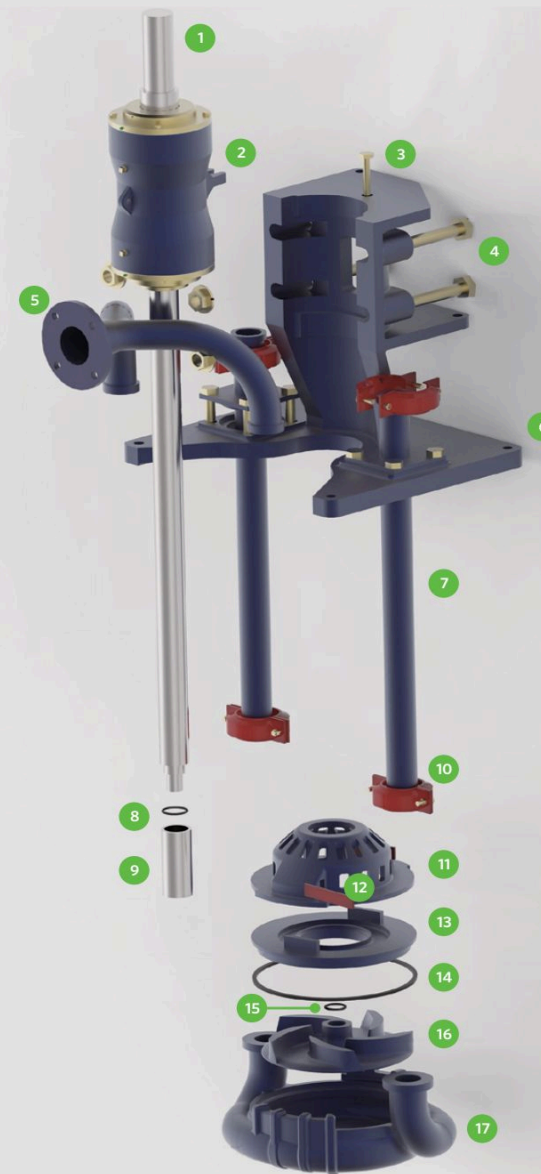

- 1 Bearing Assembly
- 2 Clamp Washer
- 3 Adjusting Screw
- 4 Clamp Bolt
- 5 Discharge Pipe
- 6 Base
- 7 Column
- 8 Shaft O-Ring
- 9 Shaft Sleeve
- 10 Salvic Joint
- 11 Strainer
- 12 Cotter
- 13 Cover Plate
- 14 Volute Cover Seal
- 15 Impeller O-Ring
- 16 Impeller
- 17 Casing

C SERIES

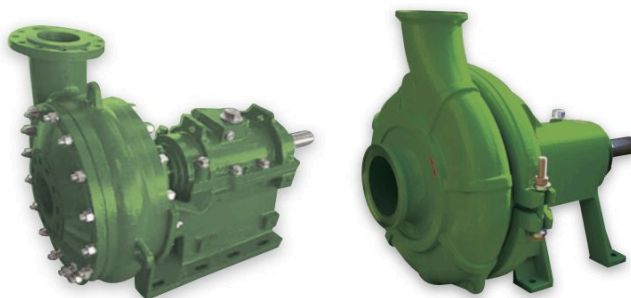

Design characteristics

- The DWW pump range has been designed to offer reliability in dewatering and process water applications.
- The DWW pump range is interchangeable with the PF150 and C5 pump.

Bearings assembly

- Supplied standard with hardened shaft sleeve, giving shaft longer lifespan
- Oil bath bearing housing

Casing

Design allows for ease of rotation and maintenance.

Impeller

- Closed impeller designed to increase efficiency.
- Adjustable impeller helps maintain efficiency.
- Efficiency as high as 70%.
- Total head up to 140m shrouds, helping to minimize recirculation and reduce pressure in the stuffing box.

Sealing options

Stuffing box and expeller seal.

Applications and Commodities

- Slurry transfer
- General slurry duties
- Tailings disposal
- Supplying water to paint

Flow Coverage Map

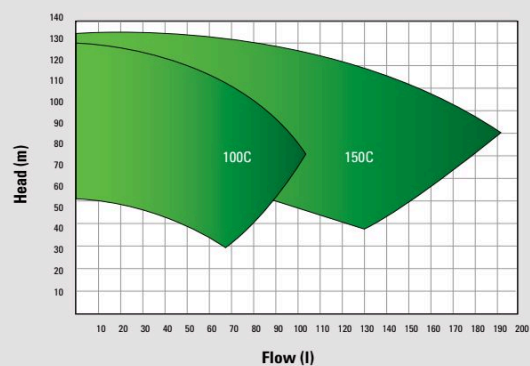

Exploded View



- | | | |
|--------------------|----------------------|-----------------------|
| 1 Adjusting Plug | 8 Shaft Sleeve | 15 Suction Cover Stud |
| 2 Adjusting Pin | 9 Gland | 16 Impeller |
| 3 Breather Kit | 10 Stuffing Box | 17 Suction Liner |
| 4 Pedestal Cap | 11 Engine Cover Stud | 18 Suction Cover |
| 5 Bearing Assembly | 12 Engine Cover | 19 Pedestal |
| 6 Barrel Nipple | 13 Casing | |
| 7 Gland Bolt | 14 Engine Liner | |

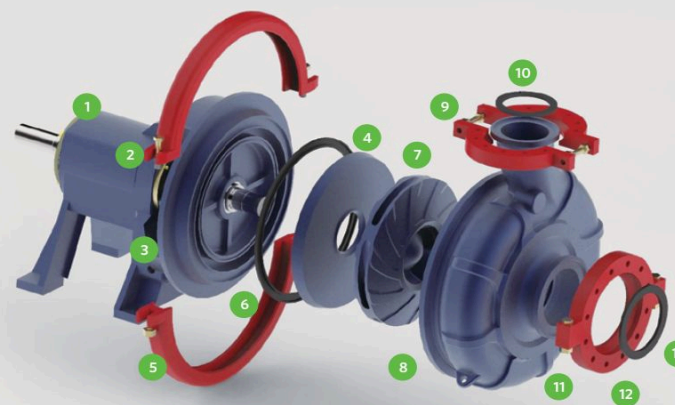

- | | |
|------------------|------------------------------|
| 1 Mechanical End | 8 Casing |
| 2 Clamp washer | 9 Discharge or intake Flange |
| 3 Flinger | 10 Discharge Ring |
| 4 Backliner | 11 Stud |
| 5 Volute clamp | 12 Intake Flange |
| 6 Volute seal | 13 Intake Ring |
| 7 Impeller | |

W SERIES

Design characteristics

The growing mining slurry pump range features an updated high efficiency seal improving efficiency up to 15% the impeller design reduces pressure at the gland while maintaining a high efficiency at suction. Various materials of construction are available.

GRW Pump Range Info

- Discharge size 4", 6", 8", 10".
- 3 Vane impeller design.
- Unlined casing.
- Newly developed high efficient seal

Gravel Pump Range

- Coarse sand
- Coarse tailings
- Heavy media
- Dredging
- Mineral sands
- Coal
- Supplying water to plant



Exploded View W-Series



- | | | |
|----------------------|-----------------------------|---------------------|
| 1 Bearing assembly | 11 Clamp washer | 21 Salvic Joint |
| 2 Clamp washer | 12 FPLI Stud | 22 Volute clamp |
| 3 Gland assembly | 13 Expeller Seal | 23 Cover plate |
| 4 Gland bolt | 14 Impeller O-Ring | 24 Salvic Joint |
| 5 Shaft Sleeve | 15 Expeller Ring | 25 Frame plate |
| 6 Lantern Ring | 16 Expeller | 26 Frame plate stud |
| 7 Packing | 17 Frame Plate liner insert | 27 Base |
| 8 Neck Ring | 18 Impeller | 28 Clamp down bolt |
| 9 Shaft O-Ring | 19 Volute frame seal | 29 Adjusting screw |
| 10 Hexagon head bolt | 20 Volute | |

Interchangeable Pump Chart

Part Number:

Reference:

A Series	AH Series
25B-A/R/M	1.5/1B-AH (R/M)
32B-A/R/M	2/1.5B-AH (R/M)
50C-A/R/M	3/2 C- AH (R/M)
80D-A/R/M	4/3 D- AH (R/M)
100E-A/R/M	6/4E -AH (R/M)
150F-A/R/M	8/6F -AH (R/M)
200F-A/R/M	10/8F-AH (R/M)
200G-A/R/M	10/8G-AH (R/M)
250F-A/R/M	12/10F-AH (R/M)
250G-A/R/M	12/10G-AH (R/M)
300F-A/R/M	14/12F-AH (R/M)
300G-A/R/M	14/12G-AH (R/M)
350G-A/R/M	16/14G-AH (R/M)
450G-A/R/M	20/18G-AH (R/M)

B Series

MP series

50C-B	3/2C-MP
80D-B	4/3D- MP
100E-B	6/4E -MP
150F-B	8/6F -MP
200F-B	10/8F-MP
250F-B	12/10F-MP

C Series

PCH series

2750C	C5 LP(2750 kpa)
6990C	C5 HP(6990 kpa)
150C	PF150

D Series

DTV series

990D	DTV990
1370D	DTV1370
1830D	DTV1830
2740D	DTV2740

Part Number:

Reference:

E Series	L series
200E-R/M	200FL-(R/M)
250E-R/M	250FL-(R/M)
300E-R/M	300FL-(R/M)
350ER/M	350FL-(R/M)

W Series

G series

100W-D	6/4DG
150W-E	6/6EG
150W-F	8/6FG
200W-F	10/8FG
250W-F	12/10FG

S Series

SP series

40S	40PV SP
65S	65QV SP
100S	100RV SP
150S	150SV SP
200S	200SV SP

SR Series

SPR series

40S	40PV SPR
65SR	65QV SPR
100SR	100RV SPR
150SR	150SV SPR

